

801 General Purpose Hose

For use with "Push-Lok" Fittings



# Part Number	Hose I.D.		Hose O.D.		Working Pressure		Burst Pressure		Minimum Bend Radius		Weight		UHg		Parkrimp Fitting		Field Attachable Fitting	
	inch	mm	inch	mm	psi	MPa	psi	MPa	inch	mm	lbs/ft	kg/m	Inches of Hg	kPa	Series	Page	Series	Page
	801-4	1/4	6,3	0.50	13	250	1,7	1000	7	2-1/2	65	0.09	0,13	28	6			82
801-6	3/8	10	0.63	16	250	1,7	1000	7	3	75	0.11	0,16	28	6			82	B-233
801-8	1/2	12,5	0.78	20	250	1,7	1000	7	5	130	0.18	0,27	28	6			82	B-233
801-10	5/8	16	0.91	23	250	1,7	1000	7	6	150	0.19	0,28	15	51			82	B-233
801-12	3/4	19	1.03	26	250	1,7	1000	7	7	180	0.24	0,36	15	51			82	B-233
801-16	1	25	1.28	33	175	1,2	700	4.8	10	250	0.55	0,37	15	51			82	B-233

Construction: Synthetic rubber tube; one textile braid reinforcement; MSHA synthetic rubber cover. Furnished in gray, red, yellow, black, green or blue. (Current inventory does not include 801-16-YEL or 801-16-GRN.)

Application and Temperature Range:

Widely used for shop air systems and general industrial, maintenance and automotive applications.
Petroleum based hydraulic fluids and lubricating oils within a temperature range of -40°F to +212°F (-40°C to +100°C);
Water, water/oil emulsion, and water/glycol hydraulic fluids up to +185°F (+85°C);
Air within a temperature range of -40°F to +158°F (-40°C to +70°C).

Fittings: Push-Lok 82 Series. See Section B for assembly instructions.

Note: Color code: Gray-GRA, Red-RED, Yellow-YEL, Black-BLK, Green-GRN and Blue-BLU. Specify color when ordering.
Example: For 801 3/8" I.D. blue hose, the part number is 801-6-BLU. If no color is specified, 801 Gray will be supplied.

804 Air and Water Hose

For use with "Push-Lok" Fittings



# Part Number	Hose I.D.		Hose O.D.		Working Pressure		Burst Pressure		Minimum Bend Radius		Weight		UHg		Parkrimp Fitting		Field Attachable Fitting	
	inch	mm	inch	mm	psi	MPa	psi	MPa	inch	mm	lbs/ft	kg/m	Inches of Hg	kPa	Series	Page	Series	Page
	804-4	1/4	6,3	0.50	13	125	0,9	500	3,4	2-1/2	65	0.09	0,13	28	6			82
804-6	3/8	10	0.63	16	125	0,9	500	3,4	3	75	0.11	0,16	28	6			82	B-233
804-8	1/2	12,5	0.78	20	125	0,9	500	3,4	5	130	0.18	0,27	28	6			82	B-233
804-12	3/4	19	1.03	26	125	0,9	500	3,4	7	180	0.24	0,36	15	50			82	B-233

Construction: Inner tube of EPDM synthetic rubber, a single fiber braid reinforcement and a black EPDM synthetic rubber cover.

Application and Temperature Range: Parker 804 Push-Lok Hose was specifically designed for dry air systems. Instead of lubricating the air at the air compressor, dry air systems have FRLs installed at the tool connection. This is required for applications utilizing pneumatic cylinders with special lubrication within the cylinder. Dry air is required to prevent contamination of the lubricant within the cylinder. Dry air systems may also be found in painting areas. Lubrication or humidity within the air can cause flaws in the paint finish.

Another application for 804 Push-Lok Hose is low pressure coolant lines on injection molding machines and in metal fabrication where it can be used with water and water/glycol up to +200°F (+93°C).

804 Push-Lok Hose can also be used as a low pressure drain or return hose line with phosphate ester fluids.

Water, water/oil emulsion, and water/glycol hydraulic fluids up to +200°F (+93°C)

Air up to 158°F (+70°C), including dry air systems.

Phosphate ester fluids up to +176°F (+80°C).

Fittings: Push-Lok 82 Series. See Section B for assembly instructions.

Special Assembly Instruction for 804 Hose: Do not allow tube to contact any petroleum base fluids. Use liquid soap as hose lubricant.

Note: Push-Lok hose is recommended for vacuum applications but not for cooling lines in air conditioners and heat pumps, nor for hydraulic applications where extreme pulsations are encountered. Push-Lok is not recommended for any fuel.

+ Non Standard

821 General Purpose Hose

For use with "Push-Lok" Fittings



# Part Number	Hose I.D.		Hose O.D.		Working Pressure		Burst Pressure		Minimum Bend Radius		Weight		UHg		Parkrimp Fitting		Field Attachable Fitting	
	inch	mm	inch	mm	psi	MPa	psi	MPa	inch	mm	lbs/ft	kg/m	Inches of Hg	kPa	Series	Page	Series	Page
	821-4	1/4	6,3	0.50	13	350	2,4	1400	10	2-1/2	65	0.06	0,09	28	6			82
821-6	3/8	10	0.63	16	300	2,0	1200	8	3	75	0.09	0,13	28	6			82	B-233
821-8	1/2	12,5	0.78	20	300	2,0	1200	8	5	130	0.12	0,18	28	6			82	B-233
821-10	5/8	16	0.91	23	250	1,7	1000	7	6	150	0.19	0,28	28	6			82	B-233
821-12	3/4	19	1.03	26	250	1,7	1000	7	7	180	0.21	0,31	28	6			82	B-233

Construction: Synthetic rubber tube; one textile braid reinforcement; textile braid cover.

Application and Temperature Range:

Widely used for shop air systems and general industrial, maintenance and automotive applications.

Petroleum based hydraulic fluids and lubricating oils within a temperature range of -40°F to +212°F (-40°C to +100°C);

Water, water/oil emulsion, and water/glycol hydraulic fluids up to +185°F (+85°C);

Air within a temperature range of -40°F to +158°F (-40°C to +70°C).

Fittings: Push-Lok 82 Series. See Section B for assembly instructions.

821FR General Purpose Hose

Fire Resistant Fiber Covered
For use with "Push-Lok" Fittings



# Part Number	Hose I.D.		Hose O.D.		Working Pressure		Burst Pressure		Minimum Bend Radius		Weight		UHg		Parkrimp Fitting		Field Attachable Fitting	
	inch	mm	inch	mm	psi	MPa	psi	MPa	inch	mm	lbs/ft	kg/m	Inches of Hg	kPa	Series	Page	Series	Page
	821FR-4	1/4	6,3	0.50	13	350	2,4	1400	10	2-1/2	65	0.08	0,12	28	6			82
821FR-6	3/8	10	0.63	16	300	2,0	1200	8	3	75	0.11	0,16	28	6			82	B-233
821FR-8	1/2	12,5	0.78	20	300	2,0	1200	8	5	130	0.12	0,18	28	6			82	B-233
821FR-12	3/4	19	1.03	26	250	1,7	1000	7	7	180	0.22	0,33	28	6			82	B-233

Construction: Synthetic rubber tube; one textile braid reinforcement; fire resistant fiber cover. Colors: Furnished in black, blue, brown, green or white cover.

Application and Temperature Range:

Petroleum based hydraulic fluids and lubricating oils within a temperature range of -40°F to +212°F (-40°C to +100°C);

Water, water/oil emulsion, and water/glycol hydraulic fluids up to +185°F (+85°C);

Air within a temperature range of -40°F to +158°F (-40°C to +70°C).

Fittings: Push-Lok 82 Series. See Section B for assembly instructions.

Note: Color code: White-WHT, Brown-BRN, Black-BLK, Green-GRN and Blue-BLU. Specify color when ordering. Example: For 821FR 3/8" I.D. blue hose, the part number is 821FR-6-BLU.

Note: Push-Lok hose is recommended for vacuum applications but not for cooling lines in air conditioners and heat pumps, nor for hydraulic applications where extreme pulsations are encountered. Push-Lok is not recommended for any fuel.

+ Non Standard

421

**Hydraulic Hose - No Skive SAE 100R1
Type AT**



# Part Number	Hose I.D.		Hose O.D.		Working Pressure		Burst Pressure		Minimum Bend Radius		Weight		Parkrimp Fitting		Field Attachable Fitting	
	inch	mm	inch	mm	psi	MPa	psi	MPa	inch	mm	lbs/ft	kg/m	Series	Page	Series	Page
421-3	3/16	5	0.46	12	3000	20,7	12000	83	3-1/2	90	0.13	0,19			42	B-211
421-4	1/4	6,3	0.53	13	2750	19,0	11000	76	4	100	0.16	0,24	43	B-25	42	B-211
421-5	5/16	8	0.59	15	2500	17,2	10000	69	4-1/2	115	0.18	0,27	43	B-25	42	B-211
421-6	3/8	10	0.68	17	2250	15,5	9000	62	5	130	0.23	0,34	43	B-25	42	B-211
421-8	1/2	12,5	0.81	20	2000	13,8	8000	55	7	180	0.29	0,43	43	B-25	42	B-211
421-10	5/8	16	0.94	24	1500	10,3	6000	41	8	200	0.33	0,49	43	B-25	42	B-211
421-12	3/4	19	1.09	28	1250	8,6	5000	35	9-1/2	240	0.42	0,63	43	B-25	42	B-211
421-16	1	25	1.40	36	1000	6,9	4000	28	12	300	0.63	0,94	43	B-25	42	B-211
421-20	1-1/4	31,5	1.73	44	625	4,3	2500	17	16-1/2	420	0.80	1,19	43	B-25		
421-24	1-1/2	38	2.00	51	500	3,5	2000	14	20	500	1.00	1,49	43	B-25		
421-32	2	51	2.50	64	375	2,6	1500	10	25	630	1.50	2,23	43	B-25		

Construction: Synthetic rubber tube; one braid of high tensile steel wire reinforcement; MSHA accepted synthetic rubber cover.

Application and Temperature Range:

Petroleum based hydraulic fluids and lubricating oils within a temperature range of -40°F to +257°F (-40°C to +125°C);
Water, water/oil emulsion, and water/glycol hydraulic fluids up to +185°F (+85°C);
Air within a temperature range of -40°F to +158°F (-40°C to +70°C).

For air or gas applications above 250 psi (1,7 MPa), the cover should be pin-pricked.

Fittings: Parkrimp 43 Series and Field Attachable 42 Series. See Section C for Parkrimp or Section B for Field Attachable fitting assembly instructions.

Hose cover does not have to be removed to attach Parker No-Skive fittings.

421HT

**Hydraulic Hose - No Skive - SAE 100R1 Type AT
(For High Temperature Service)**



# Part Number	Hose I.D.		Hose O.D.		Working Pressure		Burst Pressure		Minimum Bend Radius		Weight		Parkrimp Fitting		Field Attachable Fitting	
	inch	mm	inch	mm	psi	MPa	psi	MPa	inch	mm	lbs/ft	kg/m	Series	Page	Series	Page
421HT-4	1/4	6,3	0.53	13	2750	19,0	11000	76	4	100	0.16	0,24	43	B-25		
421HT-6	3/8	10	0.68	17	2250	15,5	9000	62	5	125	0.23	0,34	43	B-25		
421HT-8	1/2	12,5	0.81	20	2000	13,8	8000	55	7	180	0.29	0,43	43	B-25		
421HT-10	5/8	16	0.94	24	1500	10,3	6000	41	8	200	0.33	0,49	43	B-25		
421HT-12	3/4	19	1.09	28	1250	8,6	5000	35	9-1/2	240	0.42	0,63	43	B-25		
421HT-16	1	25	1.40	36	1000	6,9	4000	28	12	300	0.63	0,94	43	B-25		
421HT-20	1-1/4	31,5	1.79	45	625	4,3	2500	17	16-1/2	420	0.80	1,19	43	B-25		
421HT-24	1-1/2	38	2.00	51	500	3,5	2000	14	20	500	1.00	1,49	43	B-25		
421HT-32	2	51	2.54	64	375	2,6	1500	10	25	630	1.50	2,23	43	B-25		

Construction: Synthetic rubber tube; single high tensile steel wire braid reinforcement; MSHA accepted synthetic rubber cover.

Application and Temperature Range:

Petroleum based hydraulic fluids and lubricating oils within a temperature range of -50°F to +302°F (-46°C to +150°C);
Water, water/glycol, and water/oil emulsion hydraulic fluids up to +185°F (+85°C);
Air within a temperature range of -40°F to +158°F (-40°C to +70°C).

For air above 250 psi (1,7 MPa), the cover should be pin-pricked.

Fittings: Parkrimp 43 Series. See Section C for assembly instructions.

Hose cover does not have to be removed to attach Parker No-Skive fittings.

+ Non Standard

42 Series Fittings

Use with 421, 431, 436, and 481 hoses.

20642 Female JIC 37° - Swivel Straight

~ These 20642 fittings contain a dual seat that accepts both the JIC (37°) and SAE (45°) male configurations. The -6 SAE (45°) swivel fitting is shown under part number 20842.

Note: "C" - Stainless Steel Fitting.

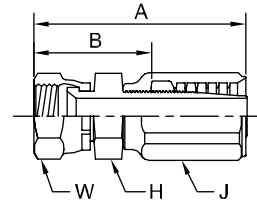

# Part Number	Thread			Hose		A		H	J	W	B	
	inch			inch		inch	mm	inch	inch	inch	inch	mm
20642-4-3~	1/4	7/16x20	-4	3/16	-3	2.35	60	9/16	5/8	9/16	1.57	40
20642-4-4~	1/4	7/16x20	-4	1/4	-4	2.43	62	9/16	11/16	9/16	1.51	38
20642-4-4C~	1/4	7/16x20	-4	1/4	-4	2.43	62	9/16	11/16	9/16	1.51	38
20642-4-6~+	1/4	7/16x20	-4	3/8	-6	2.68	68	9/16	7/8	9/16	1.53	39
20642-5-4~	5/16	1/2x20	-5	1/4	-4	2.50	64	5/8	11/16	5/8	1.60	41
20642-5-5~	5/16	1/2x20	-5	5/16	-5	2.53	64	5/8	13/16	5/8	1.58	40
20642-5-6~+	5/16	1/2x20	-5	3/8	-6	2.74	70	3/4	7/8	5/8	1.59	40
20642-6-4	3/8	9/16x18	-6	1/4	-4	2.52	64	11/16	11/16	11/16	1.62	41
20642-6-4C	3/8	9/16x18	-6	1/4	-4	2.52	64	11/16	11/16	11/16	1.62	41
20642-6-5	3/8	9/16x18	-6	5/16	-5	2.55	65	11/16	13/16	11/16	1.60	41
20642-6-6	3/8	9/16x18	-6	3/8	-6	2.75	70	11/16	7/8	11/16	1.60	41
20642-6-6C	3/8	9/16x18	-6	3/8	-6	2.75	70	11/16	7/8	11/16	1.60	41
20642-6-8+	3/8	9/16x18	-6	1/2	-8	3.05	77	11/16	7/8	7/8	1.72	44
20642-8-4~+	1/2	3/4x16	-8	1/4	-4	2.63	67	7/8	11/16	7/8	1.73	44
20642-8-6~	1/2	3/4x16	-8	3/8	-6	2.87	73	7/8	7/8	7/8	1.72	44
20642-8-6C~	1/2	3/4x16	-8	3/8	-6	2.87	73	7/8	7/8	7/8	1.72	44
20642-8-8~	1/2	3/4x16	-8	1/2	-8	3.10	79	7/8	1	7/8	1.77	45
20642-8-8C~	1/2	3/4x16	-8	1/2	-8	3.10	79	7/8	1	7/8	1.77	45
20642-8-10~+	1/2	3/4x16	-8	5/8	-10	3.31	84	15/16	1-1/8	7/8	1.89	48
20642-10-8~	5/8	7/8x14	-10	1/2	-8	3.20	81	1	1	1	1.88	48
20642-10-8C~	5/8	7/8x14	-10	1/2	-8	3.20	81	1	1	1	1.88	48
20642-10-10~	5/8	7/8x14	-10	5/8	-10	3.50	89	1	1-1/8	1	2.07	53
20642-10-12~	5/8	7/8x14	-10	3/4	-12	3.43	87	1-1/8	1-3/8	1	1.95	50
20642-12-8	3/4	1-1/16x12	-12	1/2	-8	3.40	86	1-1/4	1	1-1/4	2.06	52
20642-12-10	3/4	1-1/16x12	-12	5/8	-10	3.60	91	1-1/4	1-1/8	1-1/4	2.18	55
20642-12-12	3/4	1-1/16x12	-12	3/4	-12	3.54	90	1-1/4	1-3/8	1-1/4	2.06	52
20642-14-12	7/8	1-3/16x12	-14	3/4	-12	3.54	90	1-3/8	1-3/8	1-3/8	2.06	52
20642-14-16+	7/8	1-3/16x12	-14	1	-16	3.73	95	1-3/8	1-5/8	1-3/8	2.19	56
20642-16-12	1	1-5/16x12	-16	3/4	-12	3.62	92	1-1/2	1-3/8	1-1/2	2.14	54
20642-16-16	1	1-5/16x12	-16	1	-16	3.80	97	1-1/2	1-5/8	1-1/2	2.27	58
20642-20-16	1-1/4	1-5/8x12	-20	1	-16	3.98	101	2	1-5/8	2	2.44	62

+ Non-Standard

42 Series Fittings

Use with 421, 431, 436, and 481 hoses.

**23742 Female JIC 37° - Swivel
45° Elbow - Short Drop**

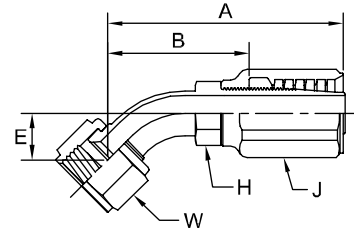

~ These 23742 fittings contain a dual seat that accepts both the JIC (37°) and SAE (45°) male configurations. The other sizes accept the JIC (37°) male configurations only.

# Part Number	Thread			Hose		A		E		H	J	W	B	
	inch			inch		inch	mm	inch	mm	inch	inch	inch	inch	mm
23742-4-4~	1/4	7/16x20	-4	1/4	-4	2.67	68	0.33	8	7/16	11/16	9/16	1.77	45
23742-6-6	3/8	9/16x18	-6	3/8	-6	3.03	77	0.39	10	9/16	7/8	11/16	1.88	48
23742-8-6~+	1/2	3/4x16	-8	3/8	-6	3.29	84	0.55	14	11/16	7/8	7/8	2.13	54
23742-8-8~	1/2	3/4x16	-8	1/2	-8	3.45	88	0.55	14	11/16	1	7/8	2.13	54
23742-10-8~	5/8	7/8x14	-10	1/2	-8	3.51	89	0.64	16	13/16	1	1	2.18	55
23742-10-10~	5/8	7/8x14	-10	5/8	-10	3.73	95	0.64	16	7/8	1-1/4	1	2.30	58
23742-10-12~+	5/8	7/8x14	-10	3/4	-12	3.66	93	0.64	16	15/16	1-3/8	1	2.18	55
23742-12-10+	3/4	1-1/16x12	-12	5/8	-10	4.05	103	0.78	20	15/16	1-1/4	1-1/4	2.63	67
23742-12-12	3/4	1-1/16x12	-12	3/4	-12	3.99	101	0.78	20	15/16	1-3/8	1-1/4	2.50	64
23742-16-12+	1	1-5/16x12	-16	3/4	-12	4.13	105	0.89	23	1-1/4	1-3/8	1-1/2	2.58	66
23742-16-16	1	1-5/16x12	-16	1	-16	4.32	110	0.89	23	1-1/4	1-5/8	1-1/2	2.66	68

**23942 Female JIC 37° - Swivel
90° Elbow - Short Drop**

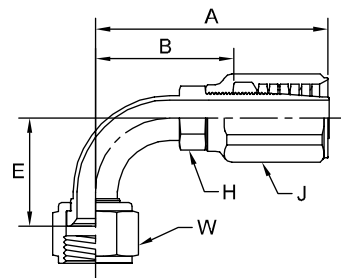

~ These 23942 fittings contain a dual seat that accepts both the JIC (37°) and SAE (45°) male configurations. The other sizes accept the JIC (37°) male configurations only.

# Part Number	Thread			Hose		A		E		H	J	W	B	
	inch			inch		inch	mm	inch	mm	inch	inch	inch	inch	mm
23942-4-4~	1/4	7/16x20	-4	1/4	-4	2.50	64	0.83	21	7/16	11/16	9/16	1.58	40
23942-6-6	3/8	9/16x18	-6	3/8	-6	2.93	74	0.85	22	9/16	7/8	11/16	1.78	45
23942-8-6~	1/2	3/4x16	-8	3/8	-6	3.05	77	1.09	28	11/16	7/8	7/8	1.90	48
23942-8-8~	1/2	3/4x16	-8	1/2	-8	3.22	82	1.09	28	11/16	1	7/8	1.90	48
23942-10-8~	5/8	7/8x14	-10	1/2	-8	3.37	86	1.23	31	13/16	1	1	2.04	52
23942-10-10~	5/8	7/8x14	-10	5/8	-10	3.59	91	1.23	31	7/8	1-1/4	1	2.16	55
23942-10-12~+	5/8	7/8x14	-10	3/4	-12	3.52	89	2.24	57	15/16	1-3/8	1	2.04	52
23942-12-10+	3/4	1-1/16x12	-12	5/8	-10	3.97	101	1.82	46	15/16	1-1/4	1-1/4	2.55	65
23942-12-12	3/4	1-1/16x12	-12	3/4	-12	3.91	99	1.82	46	15/16	1-3/8	1-1/4	2.43	62
23942-16-12+	3/4	1-5/16x12	-16	3/4	-12	3.91	99	2.00	51	15/16	1-3/8	1-1/2	2.43	62
23942-16-16	1	1-5/16x12	-16	1	-16	4.35	110	2.14	54	1-1/4	1-5/8	1-1/2	2.81	71

+ Non-Standard

42 Series Fittings

Use with 421, 431, 436, and 481 hoses.

JIC

24142 Female JIC 37° - Swivel 90° Elbow - Long Drop

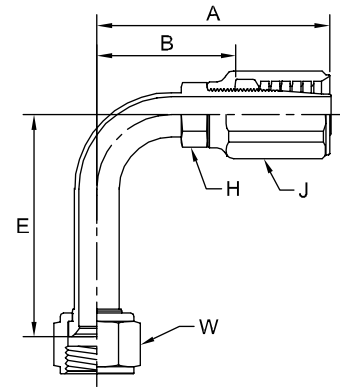

~ These 24142 fittings contain a dual seat that accepts both the JIC (37°) and SAE (45°) male configurations. The other sizes accept the JIC (37°) male configurations only.

# Part Number	Thread			Hose		A		E		H	J	W	B	
	inch			inch		inch	mm	inch	mm	inch	inch	inch	inch	mm
24142-4-4~	1/4	7/16x20	-4	1/4	-4	2.66	68	1.80	46	7/16	11/16	9/16	1.76	45
24142-6-4+	3/8	9/16x18	-6	1/4	-4	2.66	68	2.18	55	5/8	11/16	11/16	1.76	45
24142-6-6	3/8	9/16x18	-6	3/8	-6	2.92	74	2.18	55	9/16	7/8	11/16	1.78	45
24142-8-6~+	1/2	3/4x16	-8	3/8	-6	3.13	80	2.43	62	11/16	7/8	7/8	1.98	50
24142-8-8~	1/2	3/4x16	-8	1/2	-8	3.30	84	2.43	62	11/16	1	7/8	2.00	51
24142-10-8~	5/8	7/8x14	-10	1/2	-8	3.43	87	2.57	65	13/16	1	1	2.13	54
24142-10-10~	5/8	7/8x14	-10	5/8	-10	3.66	93	2.57	65	7/8	1-1/4	1	2.23	57
24142-12-12	3/4	1-1/16x12	-12	3/4	-12	3.80	97	3.73	95	15/16	1-3/8	1-1/4	2.31	59
24142-16-16	1	1-5/16x12	-16	1	-16	4.20	107	4.33	110	1-1/4	1-5/8	1-1/2	2.66	68

24842 Female JIC 37° - Swivel under Pressure - Straight

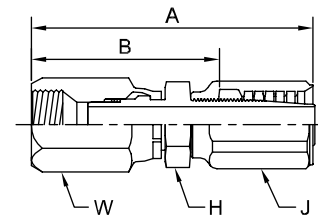

~ These 24842 fittings contain a dual seat that accepts both the JIC (37°) and SAE (45°) male configurations. The other sizes accept the JIC (37°) male configurations only.

Note: The 24842 fitting allows minor movement under pressure to relieve stress on hose but is not recommended for continuous or extensive swiveling.

Note: O-ring not compatible with Phosphate Ester fluids.

# Part Number	Thread			Hose		A		H	J	W	B	
	inch			inch		inch	mm	inch	inch	inch	inch	mm
24842-6-4	3/8	9/16x18	-6	1/4	-4	3.70	94	5/8	11/16	3/4	2.80	71
24842-8-6~	1/2	3/4x16	-8	3/8	-6	3.98	101	7/8	7/8	7/8	2.83	72
24842-10-8~	5/8	7/8x14	-10	1/2	-8	4.42	112	1	1	1	3.09	78
24842-14-12	7/8	1-3/16x12	-14	3/4	-12	4.80	122	1-3/8	1-3/8	1-3/8	3.32	84
24842-16-16	1	1-5/16x12	-16	1	-16	5.06	129	1-1/2	1-5/8	1-1/2	3.52	89

+ Non-Standard

42 Series Hose Assembly Instructions

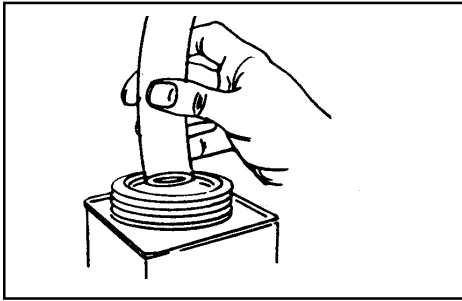

1. Identify Over All Length (OAL) of hose assembly and the Cut Off Allowance (COA) length of fitting(s) on hose ends by use of the fitting data table. Properly measure, mark and cut hose to desired length using fine tooth hacksaw or a cutoff machine. Dip hose end into Hoze-Oil or heavy oil.

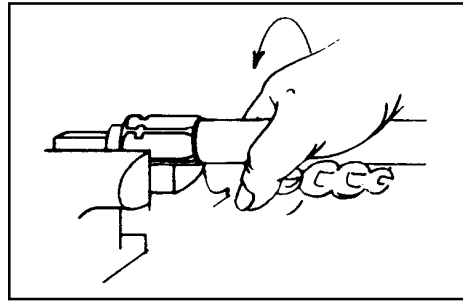

2. Place socket in vice and screw in hose counter-clockwise until hose bottoms. Back hose out 1/2 turn.

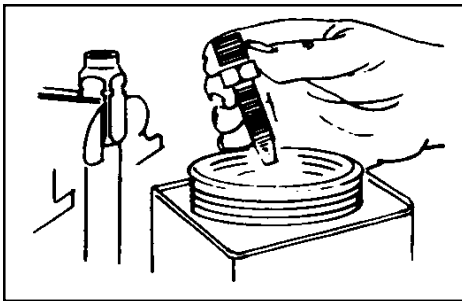

3. Dip hose end of nipple into Hoze-Oil or other heavy oil up to the hex. When assembling fittings of 316 stainless steel lubricate the threads of both the socket and nipple with Dow Corning Molykote G-n or equivalent metal assembly lubricant.

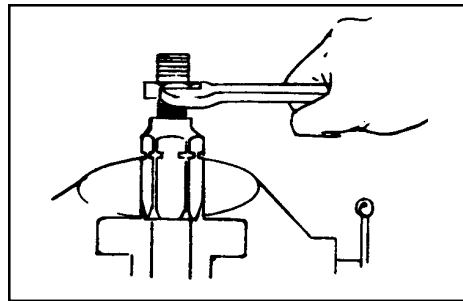

4. Screw nipple assembly into socket using wrench on nipple hex until nipple hex shoulders against socket.

Note: Disassemble in reverse order.

IF YOU HAVE QUESTIONS CONCERNING THE PRODUCTS OR APPLICATION OF THE PRODUCTS CONTAINED IN THIS CATALOG, PLEASE CALL:

PARKER HOSE PRODUCTS DIVISION - TECHNICAL SERVICES DEPARTMENT

PHONE: 440 / 943-5700

FAX: 440 / 943-3129

www.parkerhose.com

82 Series Fittings

JIC

Use with 801, 804, 821, 821FR, 831 and 836 hoses.

30682 Female JIC 37° Swivel

~ These 30682 fittings contain a dual seat that accepts both the JIC (37°) and SAE (45°) male configurations. The -6 and -12 SAE (45°) swivel fittings are shown under part number 30882.

Note: "B" - Brass Fitting.

Note: "C" - Stainless Steel Fitting.

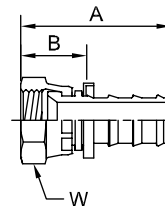

# Part Number	Thread			Hose		A		W	B	
	inch			inch		inch	mm	inch	inch	mm
30682-4-4~	1/4	7/16x20	-4	1/4	-4	1.52	39	9/16	0.76	19
30682-4-4B~	1/4	7/16x20	-4	1/4	-4	1.52	39	9/16	0.76	19
30682-4-4C~	1/4	7/16x20	-4	1/4	-4	1.52	39	9/16	0.76	19
30682-4-8B~+	1/4	7/16x20	-4	1/2	-8	1.82	46	9/16	0.76	19
30682-5-4~	5/16	1/2x20	-5	1/4	-4	1.58	40	5/8	0.83	21
30682-5-4B~	5/16	1/2x20	-5	1/4	-4	1.58	40	5/8	0.83	21
30682-5-4C~+	5/16	1/2x20	-5	1/4	-4	1.58	40	5/8	0.83	21
30682-5-6B~+	5/16	1/2x20	-5	3/8	-6	1.72	44	5/8	0.83	21
30682-6-4+	3/8	9/16x18	-6	1/4	-4	1.61	41	11/16	0.86	22
30682-6-4B	3/8	9/16x18	-6	1/4	-4	1.61	41	11/16	0.86	22
30682-6-4C+	3/8	9/16x18	-6	1/4	-4	1.61	41	11/16	0.86	22
30682-6-6	3/8	9/16x18	-6	3/8	-6	1.80	46	11/16	0.85	22
30682-6-6B	3/8	9/16x18	-6	3/8	-6	1.80	46	11/16	0.85	22
30682-6-6C	3/8	9/16x18	-6	3/8	-6	1.80	46	11/16	0.85	22
30682-6-8+	3/8	9/16x18	-6	1/2	-8	1.95	50	11/16	0.85	22
30682-6-8B+	3/8	9/16x18	-6	1/2	-8	1.95	50	11/16	0.85	22
30682-8-6~+	1/2	3/4x16	-8	3/8	-6	1.86	47	7/8	0.96	24
30682-8-6B~	1/2	3/4x16	-8	3/8	-6	1.86	47	7/8	0.96	24
30682-8-6C~+	1/2	3/4x16	-8	3/8	-6	1.86	47	7/8	0.96	24
30682-8-8~	1/2	3/4x16	-8	1/2	-8	2.01	51	7/8	0.96	24
30682-8-8B~	1/2	3/4x16	-8	1/2	-8	2.01	51	7/8	0.96	24
30682-8-8C~	1/2	3/4x16	-8	1/2	-8	2.01	51	7/8	0.96	24
30682-8-10~+	1/2	3/4x16	-8	5/8	-10	2.41	61	7/8	0.96	24
30682-10-8~+	5/8	7/8x14	-10	1/2	-8	2.03	52	1	0.98	25
30682-10-8B~	5/8	7/8x14	-10	1/2	-8	2.03	52	1	0.98	25
30682-10-10~	5/8	7/8x14	-10	5/8	-10	2.43	62	1	0.98	25
30682-10-10B~	5/8	7/8x14	-10	5/8	-10	2.43	62	1	0.98	25
30682-10-10C~	5/8	7/8x14	-10	5/8	-10	2.43	62	1	0.98	25
30682-12-8+	3/4	1-1/16x12	-12	1/2	-8	2.25	57	1-1/4	1.20	30
30682-12-8B+	3/4	1-1/16x12	-12	1/2	-8	2.25	57	1-1/4	1.20	30
30682-12-12	3/4	1-1/16x12	-12	3/4	-12	2.65	67	1-1/4	1.20	30
30682-12-12B	3/4	1-1/16x12	-12	3/4	-12	2.65	67	1-1/4	1.20	30
30682-12-12C	3/4	1-1/16x12	-12	3/4	-12	2.65	67	1-1/4	1.20	30
30682-14-12+	7/8	1-3/16x12	-14	3/4	-12	2.69	68	1-3/8	1.24	31
30682-16-12B+	1	1-5/16x12	-16	3/4	-12	2.78	71	1-3/8	1.33	34
30682-16-16+	1	1-5/16x12	-16	1	-16	2.77	70	1-3/8	1.32	34
30682-16-16B	1	1-5/16x12	-16	1	-16	2.77	70	1-3/8	1.32	34

+ Non-Standard

82 Series Fittings

JIC

Use with 801, 804, 821, 821FR, 831 and 836 hoses.

33782 Female JIC 37° - Swivel 45° Elbow - Short Drop

~ These 33782 fittings contain a dual seat that accepts both the JIC (37°) and SAE (45°) male configurations. The -6 and -12 SAE (45°) swivel fittings are shown under part number 37782.

Note: "C" - Stainless Steel Fitting.

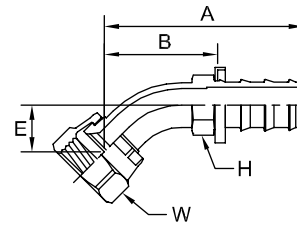

# Part Number	Thread			Hose		A		E		H	W	B	
	inch			inch		inch	mm	inch	mm	inch	inch	inch	mm
33782-4-4~	1/4	7/16x20	-4	1/4	-4	1.79	45	0.33	8	7/16	9/16	1.04	26
33782-6-6	3/8	9/16x18	-6	3/8	-6	2.10	53	0.39	10	1/2	11/16	1.20	30
33782-8-8~	1/2	3/4x16	-8	1/2	-8	2.58	66	0.55	14	5/8	7/8	1.53	39
33782-8-8C~+	1/2	3/4x16	-8	1/2	-8	2.56	65	0.55	14	5/8	7/8	1.51	38
33782-10-8~+	5/8	7/8x14	-10	1/2	-8	2.63	67	0.65	17	3/4	1	1.58	40
33782-10-10~+	5/8	7/8x14	-10	5/8	-10	3.04	77	0.64	16	3/4	1	1.59	40
33782-12-12+	3/4	1-1/16x12	-12	3/4	-12	3.36	85	0.78	20	7/8	1-1/4	1.91	49

33982 Female JIC 37° - Swivel 90° Elbow - Short Drop

~ These 33982 fittings contain a dual seat that accepts both the JIC (37°) and SAE (45°) male configurations. The -6 and -12 SAE (45°) swivel fittings are shown under part number 37982.

Note: "C" - Stainless Steel Fitting.

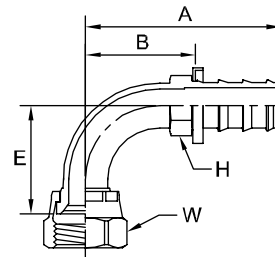

# Part Number	Thread			Hose		A		E		H	W	B	
	inch			inch		inch	mm	inch	mm	inch	inch	inch	mm
33982-4-4~	1/4	7/16x20	-4	1/4	-4	1.60	41	0.83	21	7/16	5/8	0.85	22
33982-5-4~+	5/16	1/2x20	-5	1/4	-4	1.88	48	0.77	20	7/16	5/8	1.13	29
33982-6-4+	3/8	9/16x18	-6	1/4	-4	1.84	47	0.85	22	1/2	11/16	1.08	27
33982-6-6	3/8	9/16x18	-6	3/8	-6	1.96	50	0.85	22	1/2	11/16	1.09	28
33982-8-6~+	1/2	3/4x16	-8	3/8	-6	2.18	55	1.09	28	5/8	7/8	1.27	32
33982-8-8~	1/2	3/4x16	-8	1/2	-8	2.33	59	1.09	28	5/8	7/8	1.29	33
33982-8-8C~+	1/2	3/4x16	-8	1/2	-8	2.33	59	1.09	28	5/8	7/8	1.29	33
33982-10-8~+	5/8	7/8x14	-10	1/2	-8	2.48	63	1.24	31	3/4	1	1.43	36
33982-10-10~+	5/8	7/8x14	-10	5/8	-10	2.90	74	1.23	31	3/4	1	1.45	37
33982-12-10+	3/4	1-1/16x12	-12	5/8	-10	3.26	83	1.81	46	7/8	1-1/4	1.81	46
33982-12-12	3/4	1-1/16x12	-12	3/4	-12	3.29	84	1.82	46	7/8	1-1/4	1.83	46
33982-14-12+	7/8	1-3/16x12	-14	3/4	-12	3.26	83	1.91	49	7/8	1-3/8	1.81	46

+ Non-Standard

82 Series Fittings

JIC / SAE

Use with 801, 804, 821, 821FR, 831 and 836 hoses.

34182 Female JIC 37° - Swivel 90° Elbow - Long Drop

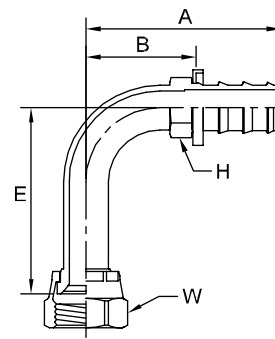

~ These 34182 fittings contain a dual seat that accepts both the JIC (37°) and SAE (45°) male configurations.

# Part Number	Thread			Hose		A		E		H	W	B	
	inch			inch		inch	mm	inch	mm	inch	inch	inch	mm
34182-4-4~	1/4	7/16x20	-4	1/4	-4	1.54	39	1.80	46	7/16	9/16	0.78	20
34182-6-6	3/8	9/16x18	-6	3/8	-6	1.97	50	2.18	55	1/2	11/16	1.08	27

30482 Male SAE 45° - Rigid Straight

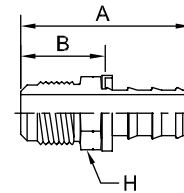

Note: "B" - Brass Fitting.

# Part Number	Thread			Hose		A		H	B	
	inch			inch		inch	mm	inch	inch	mm
30482-4-4+	1/4	7/16x20	-4	1/4	-4	1.51	38	7/16	0.76	19
30482-4-4B	1/4	7/16x20	-4	1/4	-4	1.51	38	7/16	0.76	19
30482-4-6B+	1/4	7/16x20	-4	3/8	-6	1.78	45	1/2	0.89	23
30482-5-4+	5/16	1/2x20	-5	1/4	-4	1.61	41	9/16	0.85	22
30482-5-4B	5/16	1/2x20	-5	1/4	-4	1.61	41	9/16	0.85	22
30482-5-6+	5/16	1/2x20	-5	3/8	-6	1.84	47	1/2	0.95	24
30482-5-6B+	5/16	1/2x20	-5	3/8	-6	1.84	47	1/2	0.95	24
30482-6-6+	3/8	5/8x18	-6	3/8	-6	1.84	47	5/8	0.94	24
30482-6-6B	3/8	5/8x18	-6	3/8	-6	1.84	47	5/8	0.94	24
30482-8-8+	1/2	3/4x16	-8	1/2	-8	2.15	55	3/4	1.10	28
30482-8-8B	1/2	3/4x16	-8	1/2	-8	2.15	55	3/4	1.10	28
30482-10-10+	5/8	7/8x14	-10	5/8	-10	2.70	69	7/8	1.25	32
30482-12-12+	3/4	1-1/16x14	-12	3/4	-12	2.86	73	1-1/16	1.41	36

+ Non-Standard

Use with 801, 804, 821, 821FR, 831 and 836 hoses.

Push-Lok 82 Series Assembly Instructions

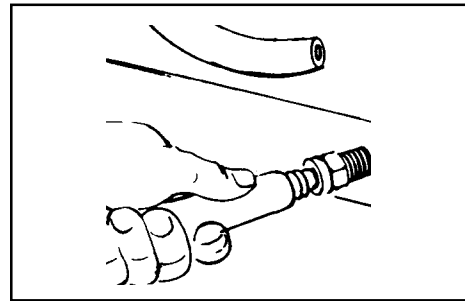
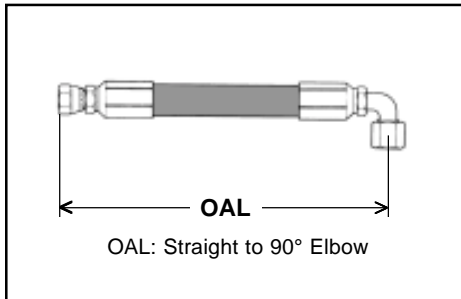

1. Identify Over All Length (OAL) of hose assembly and the Cut Off Allowance (COA) length of fitting(s) by use of the fitting data table.
2. Properly measure and mark hose. Cut hose squarely with a Parker Push-Lok cut-off tool or a sharp knife.
3. Lubricate the Push-Lok fitting, hose I.D., or both with light oil or soapy water only - DO NOT USE HEAVY OIL OR GREASE.
4. Insert fitting into hose until first barb is in the hose.
5. Place end fitting against a flat object such as a work bench or wall. Grip hose approximately one inch from end and push with a steady force until the end of the hose is covered by the yellow plastic cap.

Push-Lok 82 Series Disassembly Instructions

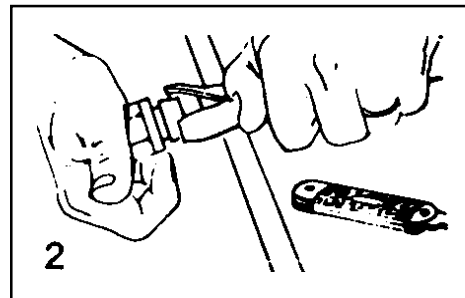
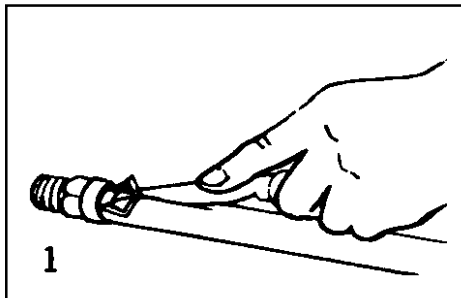

1. Leave fitting in place, and cut hose approximately one inch lengthwise from the yellow plastic cap. **IMPORTANT:** Be careful not to nick barbs when cutting hose.
2. Grip hose firmly and give it a sharp downward tug away from the fitting for disassembly.

Caution: Insert the Push-Lok fitting all the way into the Push-Lok hose until the cut end is concealed by the yellow plastic cap.
Caution: Sealing integrity may be damaged by use of exterior clamps.

IF YOU HAVE QUESTIONS CONCERNING THE PRODUCTS OR APPLICATION OF THE PRODUCTS CONTAINED IN THIS CATALOG, PLEASE CALL:

PARKER HOSE PRODUCTS DIVISION - TECHNICAL SERVICES DEPARTMENT

PHONE: 440-943-5700

FAX: 440-943-3129

www.parkerhose.com